

# TVP-CMB-01

## TruVision Corner Mount with Connection Box for P and M Series IP PTZ cameras

### General

---

The TruVision TVP-CMB-01 corner mount bracket can be used to install M and P Series IP PTZ cameras on the outside corner of a wall. The integrated junction box allows for easy cable management.



### Details

---

- Corner mount bracket with integrated junction box
- Junction box with bottom and back outlet
- Aluminium alloy and steel with surface spray treatment

# TVP-CMB-01

## TruVision Corner Mount with Connection Box for P and M Series IP PTZ cameras

### Technical specifications

#### General

Bracket type	Camera
Camera support type	PTZ camera
Bracket mounting part	Mounting bracket
Mount type	Corner mount
Cable management	Yes
Maximum load capacity	10 kg (22 lb.) - The wall must be capable of supporting at least 3 times as much as the total weight of the PTZ camera and the mount.

#### Physical

Physical dimensions	465 x 206.8 x 261.8 mm 18.31 x 8.14 x 10.31 in.
Net weight	4.3 kg 9.48 lb.
Colour	Grey (Pantone 428c)
Material	Aluminium alloy and steel

#### Environmental

Environment	Indoor / Outdoor
-------------	------------------

#### Compatible cameras

P Series IP PTZ cameras	TVGP-P0x-xxxx-PTZ-G
M Series IP PTZ cameras	TVGP-M0x-xxxx-PTZ-G

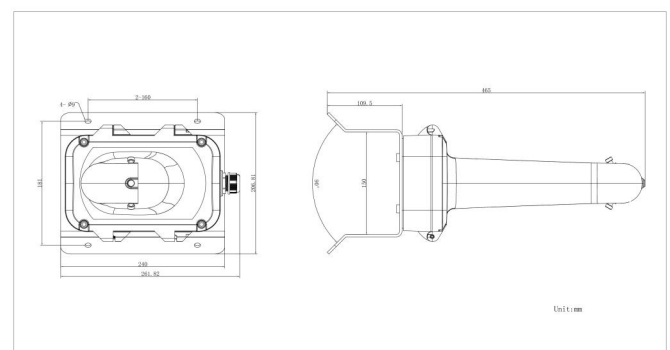

As a company of innovation, Carrier Fire & Security reserves the right to change product specifications without notice. For the latest product specifications, visit [firesecurityproducts.com](https://firesecurityproducts.com) online or contact your sales representative.

Last updated on 22 June 2022 - 9:56