

TVP-5201

TruVision 2MPX, Stainless Steel, super low light, IP PTZ Dome camera, 5.9-135.7mm x 23x zoom, True D/N, WDR, Micro SD/SDHC/SDXC slot, 24 VAC, IP67 & IK10



Details

- Stainless Steel weather resistant construction for marine and industrial type environments
- Maximum Resolution: 1920 x 1080
- Maximum Real Time Resolution: 1920 x 1080 @ 25/30 fps (50/60 Hz)
- Designed to PSIA and ONVIF Profile G and S open standards
- H.264 compression with triple-streaming functionality
- Edge recording up to 128GB SDHC card
- 1/1.9 CMOS image sensor
- Motorised IR Cut Filter
- Super Low Light: Color: 0.002 Lux @ (f1.2, AGC ON), 0 Lux IR on
- 5.9-135.7 mm lens
- Up to 120dB Wide Dynamic Range
- Intelligence (Face detection, Audio Exception Detection, Intrusion Detection, Region of Interest (ROI), Cross Line Detection, Advanced Motion Detection, Region Entrance Detection, Region Exit Detection)

TVP-5201

TruVision 2MPX, Stainless Steel, super low light, IP PTZ Dome camera, 5.9-135.7mm x 23x zoom, True D/N, WDR, Micro SD/SDHC/SDXC slot, 24 VAC, IP67 & IK10

Technical Specifications

Camera

Sensor Size	1/1.9"
Max. Resolution	1080p
Sensor Scan	Progressive
Sensor Type	CMOS
Total Pixels (H x V)	1920 x 1080
Effective Pixels (H x V)	1920 x 1080
Digital S/N ratio (dB)	50 dB (AGC Off)
Electronic Shutter	1s - 1/30,000s

Lighting performance

Wide dynamic range (WDR)	True WDR
WDR	120 dB
Digital Noise Reduction	3D DNR
Day/Night	True Day/Night
Motorized IR Cut Filter	Yes
Color Sensitivity	0.002 lux @ (F1.5, AGC ON)
B/W Sensitivity	0.0002 lux @ (F1.5, AGC ON)

Encoding

Video Streams	3
Video Compression Main Stream	H.264
Video Compression Sub Stream	H.264, M-JPEG
Video Bit Rate	128kbps to 16Mbps
Main Stream Supported Resolutions	1280 x 720 (XVGA), 1280 x 960 (720p), 1920 x 1080 (1080p)
Sub Stream Supported Resolutions	1280 x 720 (XVGA), 1280 x 960 (720p), 352 x 288 (CIF), 704 x 576 (4CIF)
Max. Resolution @ fps	1920 x 1080 @ 50 fps

Lens

Lens Type	Varifocal
Focal length	5.9-135.7mm
F-stop	f1.5 to f3.4
Auto-iris	Yes
Auto-focus	Yes
Motorized Zoom	Yes

Pan/tilt/zoom

Pan	360°
Tilt	-20° to 90°
Auto-Flip	Yes
Optical Zoom	23X
Preset Positions	32
Preset Tours	8
Shadow Tours	4
Smart Tracking	Yes

Network

Supported Video Standards	CGI, ONVIF, PSIA
Supported Network Protocols	802.1x, DDNS, DHCP, DNS, FTP, HTTP, HTTPS, IPv4, IPv6, NTP, PPPoE, Qos, RTP, RTSP, SMTP, SNMP, TCP/IP, UPnP

Audio

Audio Compression	G.711, G.722.1, G.726, MP2L2
Audio In	1
Audio Out	1

Alarm I/O

Alarm Inputs	7
Alarm Outputs	2

Storage

Local Storage Support	Yes
Local Storage Type	Built-in Micro SD/SDHC/SDXC card slot
Max Storage Capacity	128GB

Video intelligence

Basic Alarm Detection	Motion, Privacy Masking, Tamper
Video Analytics	Advanced motion detection, Audio exception, Cross line, Face detection, Intrusion detection, Region entrance detection, Region exit detection
Intelligent Tracking	Yes

General

Display Modes	ROI (Region Of Interest)
Software Compatibility	OnGuard, Prism, TruVision Navigator, TVRmobile, Web Browser

Electrical

Power supply value	24 VAC or PoE-Ultra
Power consumption	60 W

Physical

Physical dimensions	262 x 330 mm
Net weight	10 Kg
Colour	Grey
Material	Stainless Steel
Form Factor	PTZ
Rugged	IK10

Environmental

Operating temperature	-40 to +65°C
Relative humidity	<95% (non-condensing)
Environment	Outdoor
IP-rating	IP67

Standards & regulation

Compliance	CE, FCC, REACH, RoHS, UL, WEEE
------------	--------------------------------

TVP-5201

TruVision 2MPX, Stainless Steel, super low light, IP PTZ Dome camera, 5.9-135.7mm x 23x zoom, True D/N, WDR, Micro SD/SDHC/SDXC slot, 24 VAC, IP67 & IK10

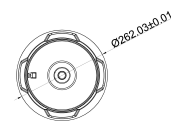
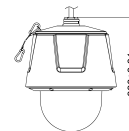

As a company of innovation, UTC Technologies reserves the right to change product specifications without notice. For the latest product specifications, visit UTC Technologies online or contact your sales representative.